

**STAINLESS STEEL
PN16 FLANGED
VERTICAL FLOW (90°) / PNEUMATIC ON-OFF VALVE**

SERIES : 402

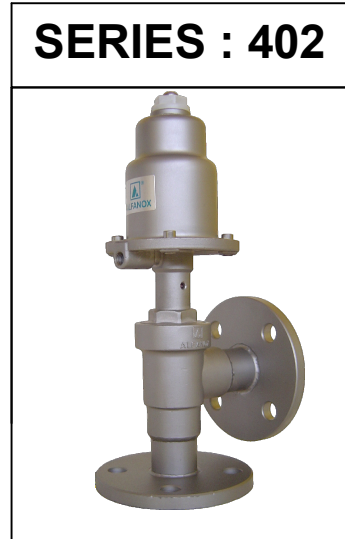

DN		PISTON	Δp bar	A	B	H	ØD	ØE	G	Kv m ³ /h	WEIGHT (KG)
15	1/2"	Ø 50	21	68	195	263	95	65	G 1/8"	4,9	1,30
		Ø 63	33		210	278					1,60
20	3/4"	Ø 50	12		195	263	105	75		7,6	1,50
		Ø 63	27		210	278					1,70
25	1"	Ø 50	7	78	195	273	115	85		13,7	1,60
		Ø 63	12		210	288					2,00
		Ø 80	27		225	303					2,60
32	1 1/4"	Ø 63	7	88	215	303	140	100		20,7	2,40
		Ø 80	12		235	323					3,00
		Ø 100	26		255	343					4,20
40	1 1/2"	Ø 63	5	98	220	318	150	110		34,2	2,80
		Ø 80	8		240	338					3,50
		Ø 100	16		260	358			4,60		
50	2"	Ø 80	5	113	245	358	165	125	48,6	3,90	
		Ø 100	10		265	378				5,00	

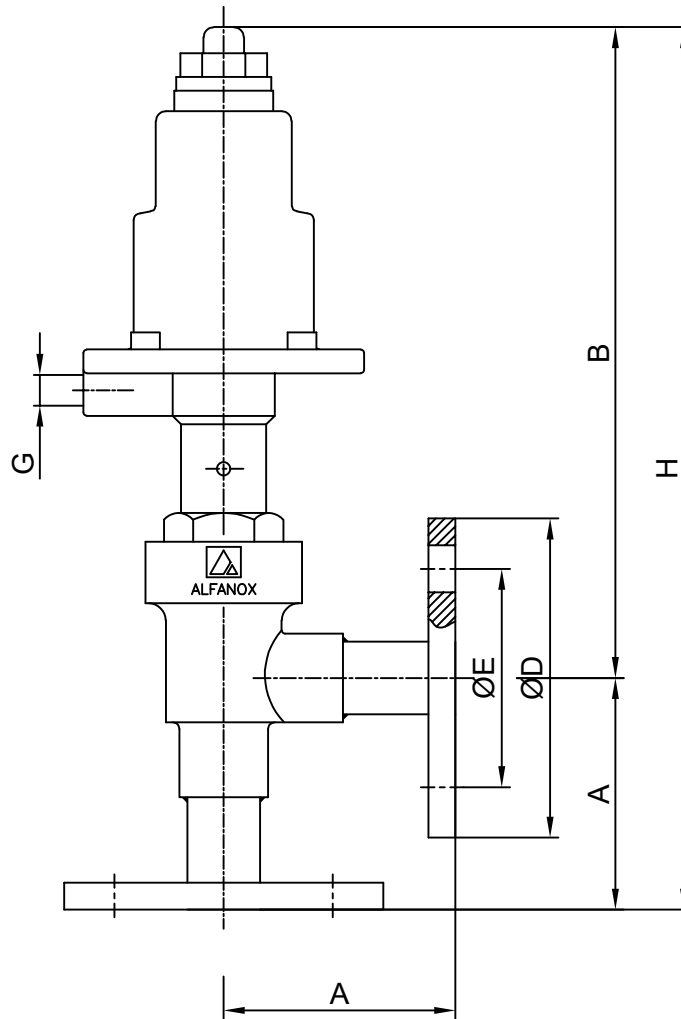

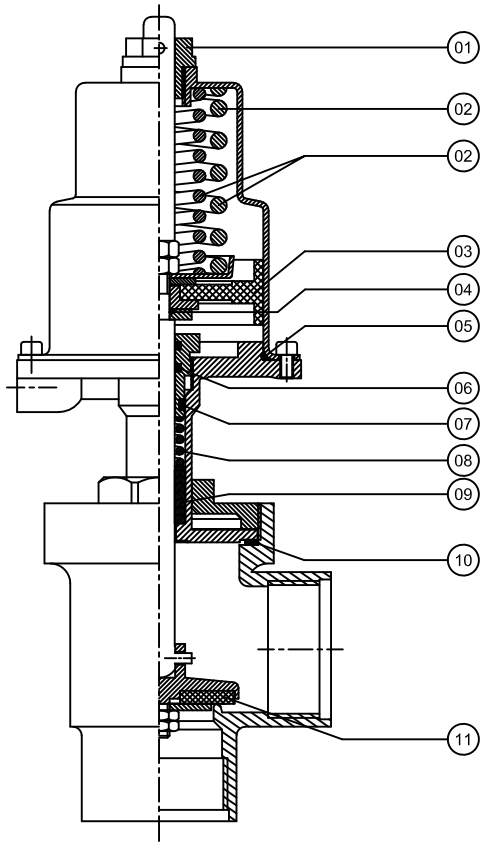

INSTRUCTIONS :

1. Valve can be fitted in any position.
2. Flow direction should be as indicated by an arrow
3. Working pressure for each size of valve should not be exceed the limits indicated in the chart.
4. Control pressure should not exceed the maximum and should not go lower then the minimum value.
5. CAUTION : Never fasten or remove the assembly nut prior to applying pressurized air.

For the spare part orders, notifying us about the part number at the chart below and also the serial number on the valve are adequate.

SPARE PART LIST		
PART NO	PART NAME	MATERIAL
01	UPPER SPINDLE GUIDE	NYLON 66
02	SPRING (SINGLE)	INOX
02	SPRING (DOUBLE)	INOX
02	SPRING (DOUBLE)	STEEL
03	PISTON GROUP	NBR+BRASS
04	PISTON O-RING	NBR
05	CYLINDER O-RING	SILICONE
06	STUFFING BOX O-RING	SILICONE
07	STUFFING BOX GASKET	SILICONE
08	STUFFING BOX SPRING	INOX
09	STUFFING BOX V-CHEVRON	PTFE
10	BODY SEALING GASKET	PTFE / SILICONE
11	SEAT SEAL	EPDM / PTFE / VITON

